



Finley Health Service's new healthcare worker accommodation is on its way

Work on the delivery of Finley key worker accommodation units is well underway following the release of the Prototype and Schematic Design earlier this year.

Planning approval has been granted and off-site manufacturing of the six accommodation units is progressing well, with site works commencing mid-September 2024 in preparation for the delivery and installation of the units in October 2024.

Once delivered, connection of services, fencing, landscaping, and furnishing of the units will take place, ready for healthcare workers to move in before the end of the year.

Accommodation Features

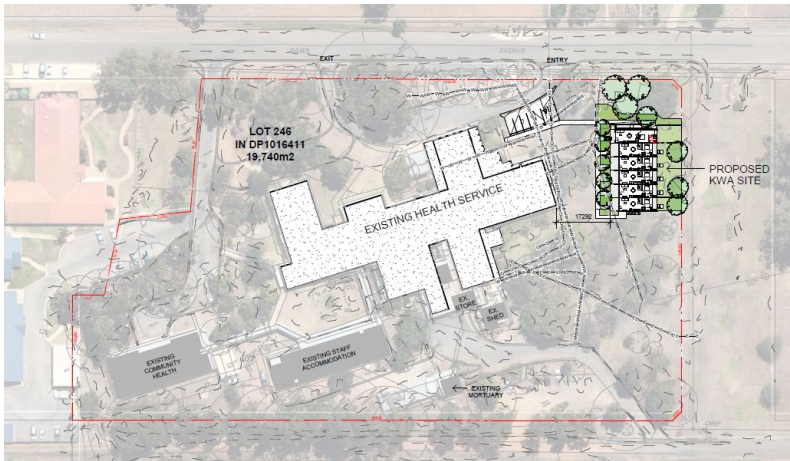

The units will be installed on the east side of the Health Service on Dawe Avenue (refer to site plan on left for indication of location).

There are six units in total, including one wheelchair accessible unit. Each fully furnished, self-contained unit features a screened verandah, a light-filled living and dining area, modern kitchen with quality appliances, bedroom with robe and ensuite, and an internal built-in laundry with a stacked washer and dryer.

Parking spaces and secure access to the units will be provided. There will also be landscaping surrounding the units.

Expected Timeline

Mid-September 2024: Hutchinson Builders establish site.

Early October 2024: Units expected to be delivered for installation.

October – November 2024: Installation, connection of services, fencing and landscaping.

Please note indicated dates are subject to change due to weather conditions or other circumstances out of our control.

Statutory requirements will be met in relation to dust and noise associated with the delivery and installation of the units, and this will be kept to a minimum.

Information will be provided during the works about any other direct impacts to the health service including access, parking or operations.

For your safety, please be aware of extra activity on site and follow any directions during this time. We thank you for your patience.

Regular updates about progress will be provided via project update newsletters, social media posts and news items.

The Key Worker Accommodation Program

The NSW Government is investing \$45.3 million to deliver modern, sustainable accommodation for health workers in three rural health districts: Murrumbidgee, Far West, and Southern NSW.

Program Benefits:

- Attract more health workers to rural and regional hospitals.
- New, fit for purpose, self-contained and spacious accommodation.
- Fully furnished, providing a safe and comfortable environment.
- Landscaping.
- Located on hospital grounds.
- Establish a community within a community allowing spaces for staff to connect with each other.

In the Murrumbidgee Local Health District, Finley, Leeton, Narrandera, and West Wyalong have been identified as sites for key worker accommodation.

To watch the Key Worker Accommodation Prototype Tour video, please visit bit.ly/4bhjbxk.

Off-site construction of the Finley KWA units in progress (September 2024)



For more information, contact:

02 8838 8889

HI-KeyWorkerAccommodation@health.nsw.gov.au

hinfra.health.nsw.gov.au